

The EN-245 InferStack™ platform meets many Internet of Things Application requirements. It is an ANSI C12 certified tariff meter for both pulse inputs and with a Modbus® RTU connected Veris CT package and the ability to connect to Building Automation Systems make this a good fit for metering, monitoring, Automated Demand Response and Analytics.

Ethernet LAN and WAN connect to plant over BACnet™ and Modbus® TCP and to enterprise servers with oBiX and Haystack protocols. 3G or 4G modem GSM or CDMA is optional. RS-485 serial connection supports BACnet™ MSTP and Modbus® RTU.

The EN-245 InferStack™ is part of a comprehensive range of Hardware, Software and Connection Services that enable Service Providers to deliver the benefits of the Internet of Things to Intelligent Buildings, Equipment and Smart Devices.

InferStack™ provides elegant, simple design Visualization of real-time and historical data with Graphics and Dashboards, the powerful B-Line control engine, custom Reporting, simple and effective Alarm and Event Handling and optional industry leading on-board Analytics.

The Platform is used for many Applications including:

- Energy Monitoring and Analysis
- Building and Plant Fault Detection and Diagnosis
- Plant Control and Optimization
- Smart Grid and Automatic Demand Response

InferStack™ incorporated the Project Haystack standard Data Modeling. A built-in Wi-Fi Access Point allows Mobile Devices to Communicate with the EN-245 Platform for ease of set-up commissioning and all visualization.



- 3G model or 4G modem option
- Ethernet LAN for BACnet™ and Modbus®
- Ethernet WAN for enterprise connection
- RS-485 BACnet™ MSTP or Modbus® RTU
- 2 pulse inputs for tariff meter

Architecture

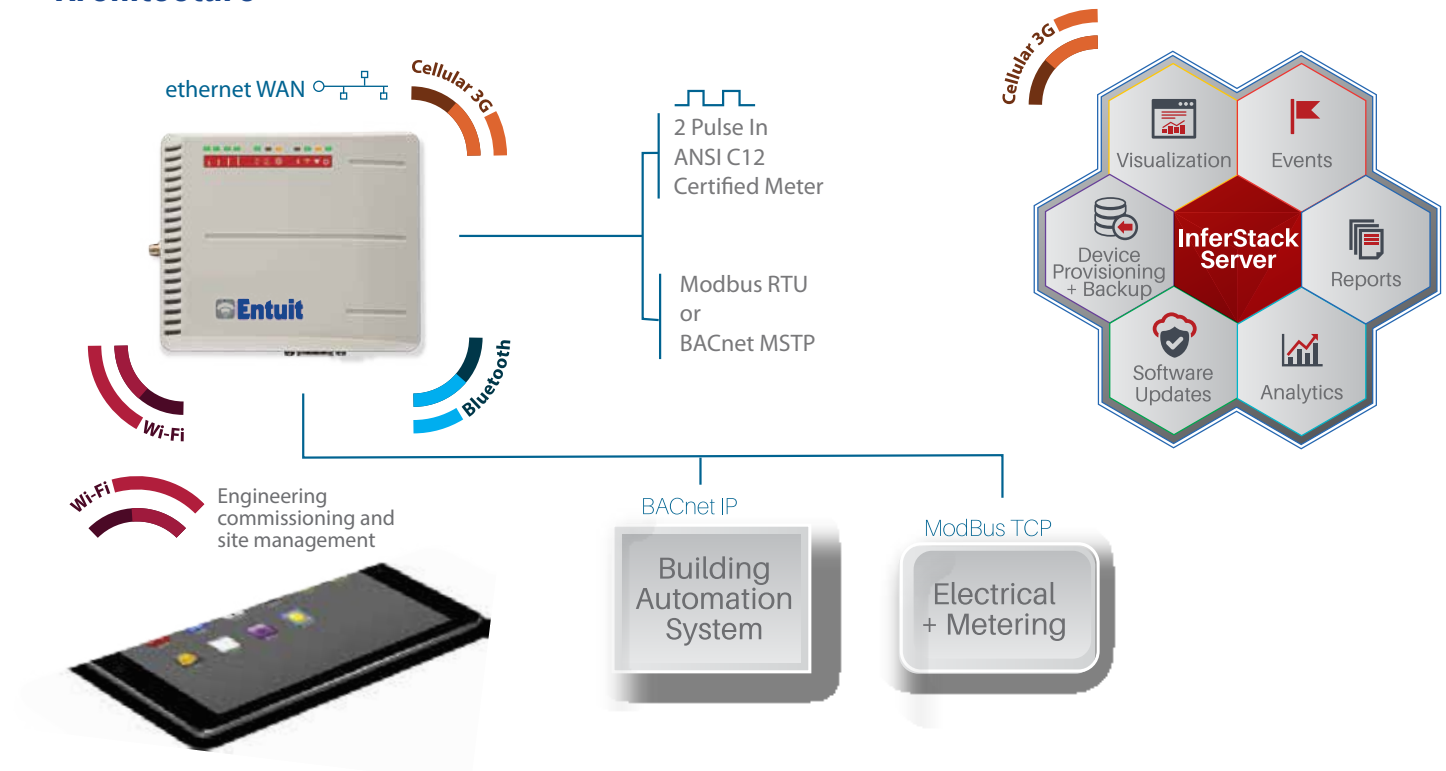

Software

InferStack™

- InferStack™ Application Environment with Project Haystack modeling.
- Wind River® Linux 5 Operating System with Java® Virtual Machine
- Serial Communication for Modbus® RTU and BacNet™ MSTP
- IP protocols Modbus® TCP, BACnet™ IP, oBIX™, Haystack™

Mounting Dimensions

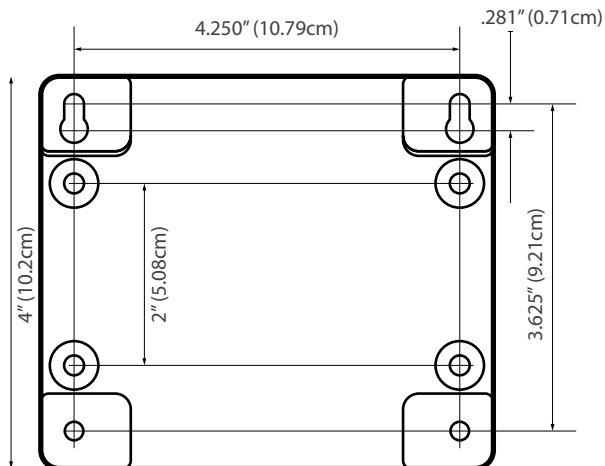

- Molded plastic case, convection cooled
- Net weight 1.0 pound (0.45 Kg)

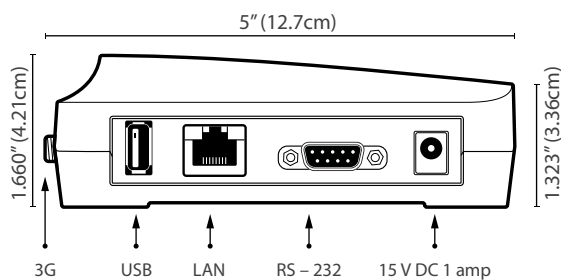

Hardware

- TI ARM Cortex™ A8 Cortex processor @ 600 MHz
- 512 MB DDR3 RAM
- 8 GB Micro SD Flash for system and application data backup
- Trusted Platform Module (TPM) for security
- 2 10/100 MBit Ethernet port
- Wi-Fi for data and user interface connectivity
- Bluetooth v4.0 BLE
- Two digital inputs for pulse counting up to 500Hz pulses at 50% duty cycle
- 1 RS-232 port: DB9 male connector
- 1 RS-485 port: 3 point terminal
- Optional 3G modem, CDMA or GSM
- Power—15 volts DC
- Rechargeable internal battery backup
- Multiple Mounting Options—Desk, Wall or Enclosure
- Environmental Operating range
0 to 50 Degrees C (32 to 122 Deg. F)
Humidity 0 to 90% RH non-condensing

Agency Listings

- UL-60950 or Met Labs equivalent
- FCC Part 15 Class B for electromagnetic and Class C for modem
- RoHS compliant
- CE compliant
- ANSI C12 Certified Meter

Ordering Information

Part Number	Description
EN-234-30	InferStack™ w/ 30 pts
EN-245-130	InferStack™ w/ 130 pts
EN-245-230	InferStack™ w/ 230 pts
EN-245-330	InferStack™ w/ 330 pts
EN-245-430	InferStack™ w/ 430 pts