

Room Temperature Sensor

ENTSD



Application

Solar-powered sensors, with an intelligent transmission management, are used to measure the room temperature, and transmit this information wirelessly using the non-proprietary EnOcean wireless protocol. The setting knob of the Mx-RTS1-SP also allows you to adjust and correct the room temperature setpoint on the sensor. Communication with the wireless partner takes place via the non-proprietary EnOcean wireless protocol. Special indoor solar cells collect the power required for operation and data transfer from ambient light. In unlit periods, maintenance-free gold-cap capacitors continue to feed the transmitter. The wireless transmission technology gives you a great deal of freedom in choosing the installation location.



Technical Data

Function	Temperature Sensor and set point control
Power Supply	Solar-powered via internal energy storage unit
Protocol	Wireless EnOcean Telegram
Profile	EEP A5-10-03 temperature sensor
Transmission Range	Approximately 100 feet (30m) depending on building structure
Duty Cycle	< 0.4%
Transmission Interval	Configurable in AirConfig. The default is based on change of value or every 15 minutes
Transmission Power	< 10 mW
Darkness Reserve	Up to 100 h via gold-cap capacitors
Operating Life With No Light	Up to 4 days
Illumination Strength	Min. 150 lx, constant
Measuring Range	0°C to 40°C
Ambient Conditions	0°C to 50°C (humidity non-condensing)
Housing	Plastic Housing, RAL9010 (pure white)
Degree of Protection	IP20
Weight	0.10 kg
Dimensions	WxHxD mm 82.5 x 82.5x 30



Entuit, Inc.

1930 Baseline Road - Grand Island, NY 14072 - phone (716) 775.9572 - www.EntuitInc.com - sales@entuitinc.com

Room Temperature Sensor

ENTSD



Wall Mounting:

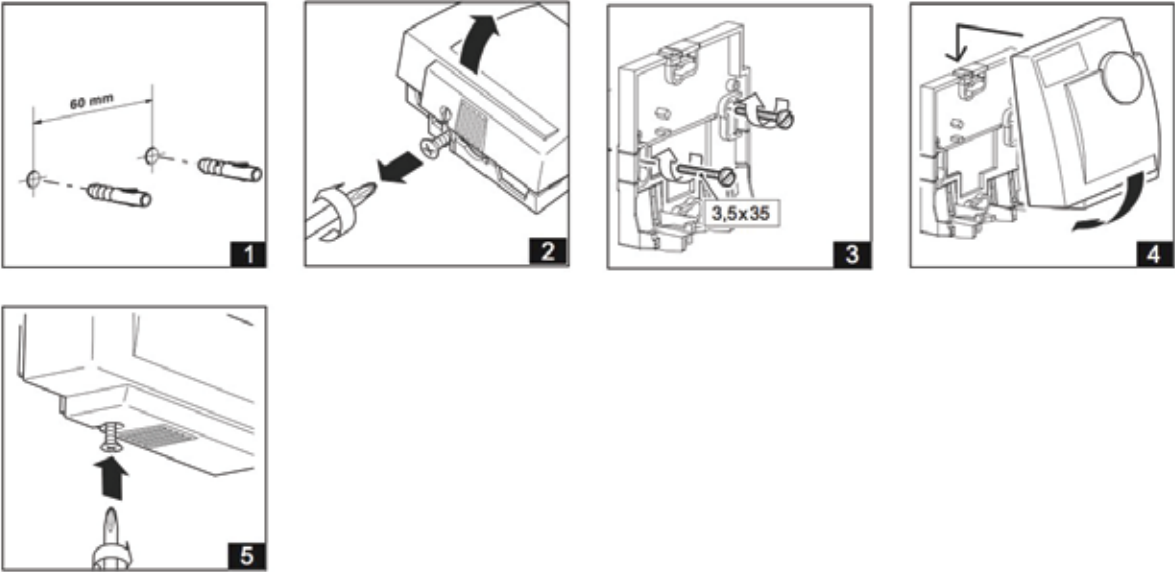

Flush Mounting:

